

AIR COOLED VERSION

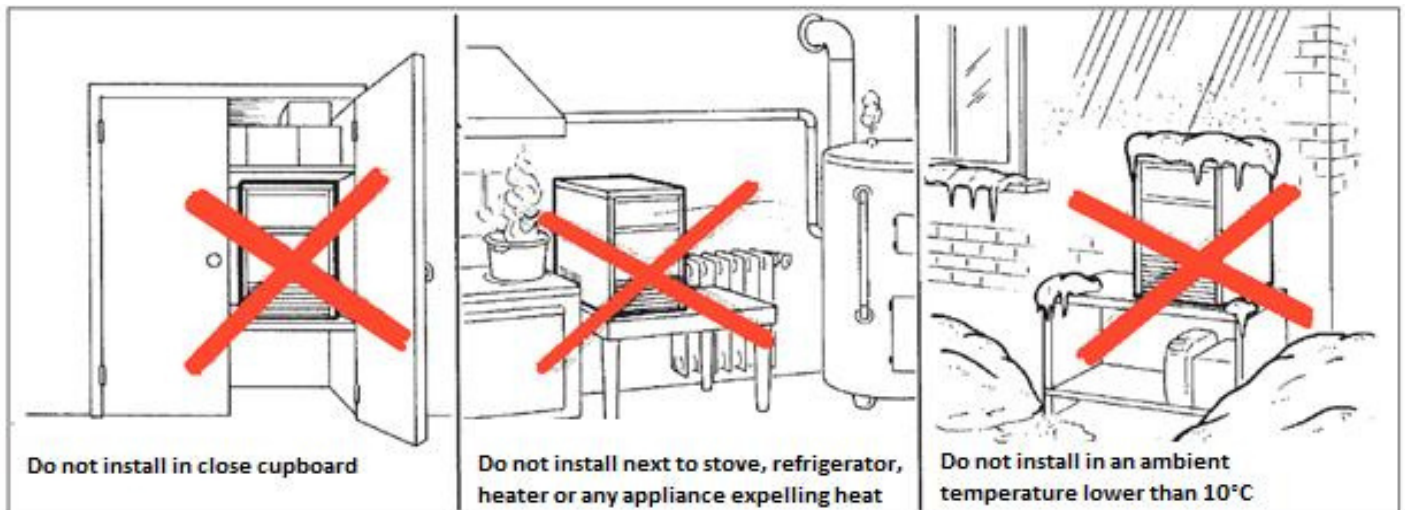

9)

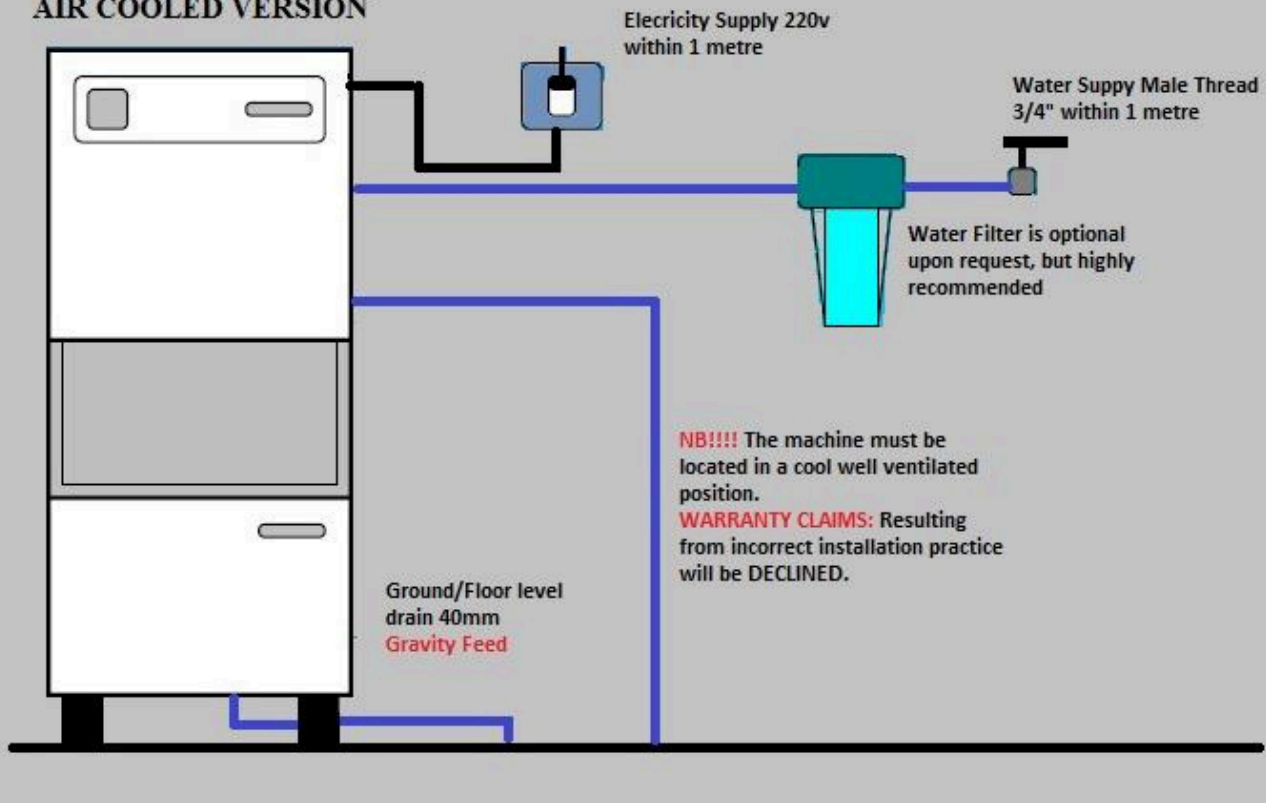

- Connect the water inlet hose provided with the ice machine to the water inlet valve situated on the back of the machine and connect the other end of the inlet hose to the water supply (3/4" male thread tap).

Min. water pressure 1 bar
Max. water pressure 5 bar
Min. water temperature 5°C (Must be connected to cold water tap)
Max. water temperature 35°C

11)



- Turn on the tap on.

10)



- Connect the water drain flexible hose supplied with the machine to the water drain fitting situated on the back of the machine using the clamp.
NB!!!! Make sure the clamp is properly secured, in order to prevent leaking.
- The other end of the flexible drain hose to go to **floor point** drain.

Machine must be at least 15 cm higher than the drain point.

12)



Switch the power on.

f.

.
